

CONTROLLO TERMICO
Attacchi Automatici per Fluidi



 HYDRAULIC
COMPONENTS
& FLUID CONTAMINATION
CONTROL



All trademarks belong to their respective owners; third party trademarks, product names, trade names, corporate names and company names mentioned may be trademarks of their respective owners or registered trademarks of other companies and are used for instructional purposes and for the benefit of the owner, without any end of Copyright infringement in force.

Tutti i marchi riportati appartengono ai legittimi proprietari; marchi di terzi, nomi di prodotti, nomi commerciali, nomi corporativi e società citati possono essere di proprietà dei rispettivi titolari o registrati da altre società e sono stati utilizzati a puro scopo esplicativo e a beneficio del possessore, senza alcun fine di violazione dei diritti di Copyright vigenti.

Auto-Couplings Fluids

- **Self-aligning feature**
- **Connection under full working pressure**
- **Panel and thread versions available**

At the core of electronic systems, CEJN's blind-mate couplings and nipples with extreme non-spill feature guarantee perfect sealing during operation. The light and compact auto-coupling is mounted on rackable/blade systems in supercomputers and data centres where DLC (Direct Liquid Cooling) technology is used. The range of products is resistant to vibration and corrosion and, if necessary, the design enables connection and disconnection under full working pressure.

TECHNICAL DATA - SERIES 767

Series 767, DN19 Brass	
Nominal flow diameter	19 mm (3/4")
Water flow (double shut-off)	221.6 l/min (48.8 GPM UK)
Max. working pressure	20 bar (290 PSI)
Kv (double shut-off)	13.30
Cv (double shut-off)	15.37
Min. burst pressure	80 bar (1160 PSI)
Temperature range	-20°C – +150°C (-4°F – +302°F)
Material coupling	Nickel-plated brass
Material nipple	Nickel-plated brass



	Connection	Part No.	Connection	Seal	Length	Diameter	Hexagon
Series 767, DN19 Brass	Coupling (Socket)	10 767 1291	G 1" (BSP) O-ring Boss, red code	EPDM	82	63	56
	Coupling (Socket)	10 767 1293	G 1" (BSP) PO-ring Boss, blue code	EPDM	82	63	56
	Nipple (Plug)	10 767 6291	G 1" (BSP) O-ring Boss, red code	EPDM	67.5	63	56
	Nipple (Plug)	10 767 6293	G 1" (BSP) O-ring Boss, blue code	EPDM	67.5	63	56

TECHNICAL DATA - DLC

	DLC, DN3 Stainless steel	DLC, DN5 Aluminum
Nominal flow diameter	3 mm (1/8")	5 mm (3/16")
Max. working pressure	16 bar (232 PSI)	10 bar (145 PSI)
Kv (double shut-off)	0.18	0.87
Cv (double shut-off)	0.21	1.02
Min. burst pressure	64 bar (928 PSI)	40 bar (580 PSI)
Connection under pressure	16 bar (232 PSI)	10 bar (145 PSI)
Temperature range	-40°C – +100°C (-40°F – +212°F)	-40°C – +100°C (-40°F – +212°F)
Material coupling	AISI 316L Stainless steel	Surface treated aluminum alloy
Material nipple	AISI 316L Stainless steel	Surface treated aluminum alloy
Material seal	NBR Low temp -40°C - +80°C (-40°F - +176°F), EPDM -30°C - +100°C (-22°F - +212°F)	NBR low temp -40°C - +80°C (-40°F - +176°F) or EPDM -30°C - +100°C (-22°F - +212°F)

	Connection	Type	Part No.	Connection	A	B	D	E	F	G
DLC, DN3 Stainless steel	Couplings	Male thread	10 150 1540	M11 x 1	29.1	15	-	18.8	-	NBR
	Couplings	Male thread	10 150 1544	M11 x 1	29.1	15	-	18.8	-	EPDM
	Nipples	Male thread	10 150 6540	M11 x 1	29.8	15	-	19.5	-	NBR
	Nipples	Male thread	10 150 6544	M11 x 1	29.8	15	-	19.5	-	EPDM
DLC, DN5 Aluminum	Couplings	Male thread	10 150 1900	M19x1	36.8	20.5	18.0	17.0	-	NBR
	Couplings	Male thread	10 150 1921	M19x1	36.8	20.5	18.0	17.0	-	EPDM
	Couplings	Panel mount	10 150 1901	For 4x screws (M3)	36.8	37.0	28.0	17.0	-	NBR
	Couplings	Panel mount	10 150 1922	For 4x screws (M3)	36.8	37.0	28.0	17.0	-	EPDM
	Nipples	Male thread	10 150 6900	M16x0,75	37.5	17.5	16.0	20.5	-	NBR
	Nipples	Male thread	10 150 6921	M16x0,75	37.5	17.5	16.0	20.5	-	EPDM
	Nipples	Panel mount	10 150 6901	For 4x screws (M3)	37.5	29.0	22.3	20.5	-	NBR
	Nipples	Panel mount	10 150 6922	For 4x screws (M3)	37.5	29.0	22.3	20.5	-	EPDM

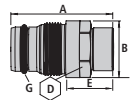

LubeTeam Hydraulic S.r.l.

Administration and Headquarter:

Via Tufara Scautieri, 6

83018 - San Martino Valle Caudina (AV)

Office and Warehouse:

S.S. 7 Appia, Km. 237,00

82011 - Airola BN

ITALY

Tel. +39 0823 950 994

Fax +39 0823 412 546

www.lubeteam.it info@lubeteam.it

Italian VAT / C.F. e P.IVA: 01251720627

Follow us



This document is the property of LubeTeam Hydraulic S.r.l. All data reported here are for the exclusive use of the Receiver. Reproduction is not authorized without writing permission, in all or in part of the content of this document, in accordance to Law 633 art. 171, dated April 22, 1941.

Il presente documento è di proprietà della LubeTeam Hydraulic S.r.l. I dati riportati sono per esclusivo del destinatario. La riproduzione, di tutto o in parte, non è autorizzata senza permesso scritto secondo l'art. 171 della L. 633 del 22 Aprile 1941.