

Tierre
Pneumatica
Innesti rapidi in ottone



 HYDRAULIC
COMPONENTS
& FLUID CONTAMINATION
CONTROL



All trademarks belong to their respective owners; third party trademarks, product names, trade names, corporate names and company names mentioned may be trademarks of their respective owners or registered trademarks of other companies and are used for instructional purposes and for the benefit of the owner, without any end of Copyright infringement in force.

Tutti i marchi riportati appartengono ai legittimi proprietari; marchi di terzi, nomi di prodotti, nomi commerciali, nomi corporativi e società citati possono essere di proprietà dei rispettivi titolari o registrati da altre società e sono stati utilizzati a puro scopo esplicativo e a beneficio del possessore, senza alcun fine di violazione dei diritti di Copyright vigenti.

INNESTI RAPIDI IN OTTONE

MADE IN ITALY

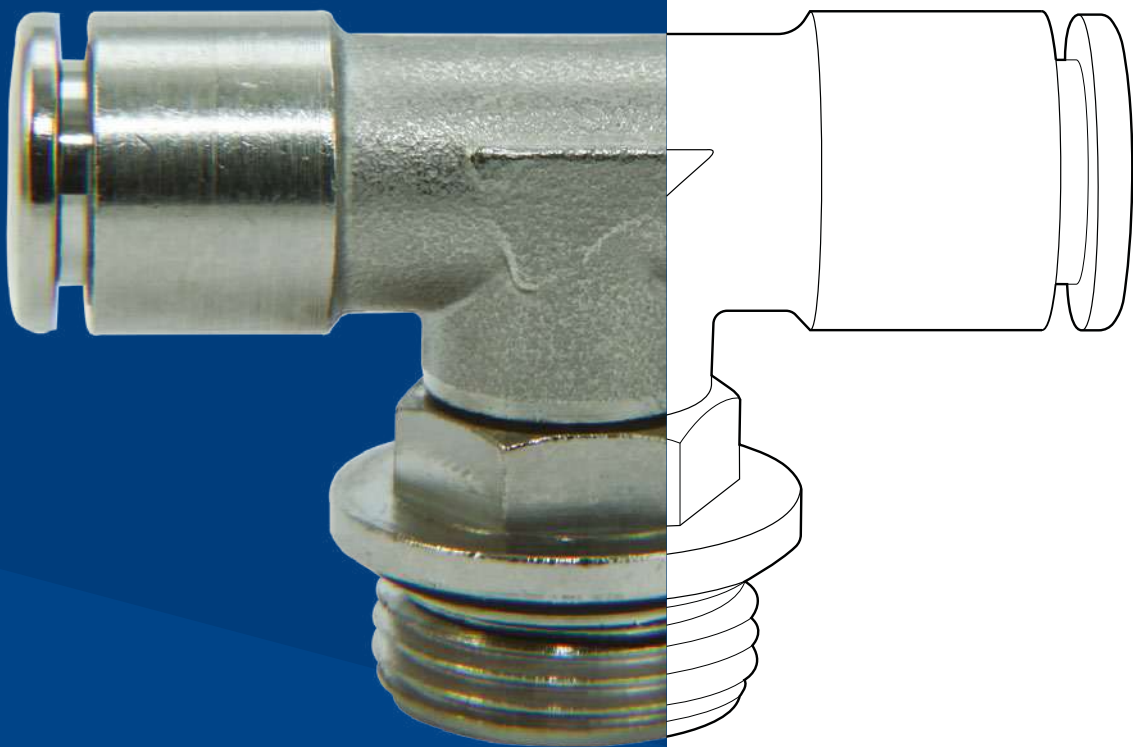



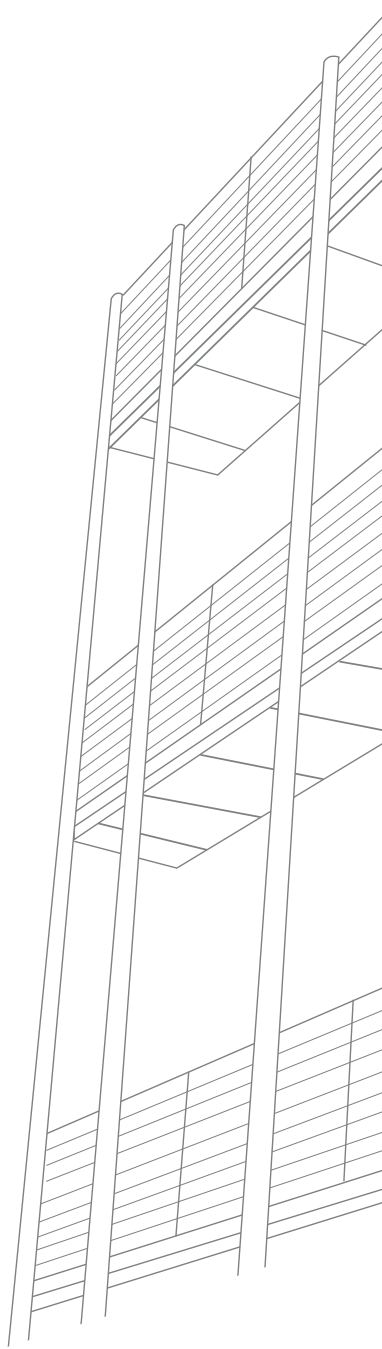

 **TierreGroup**[®]
INDUSTRIAL AUTOMATION
HYGIENIC&FOOD FOOD&BEVERAGE

 **TierreFittings**[®]

 **F-Line**[®]

 **NET.Fit**[®]

 **INOX.Fit**[®]



INNESTI RAPIDI IN OTTONE

PLUS

Raccordi di facile utilizzo con
PRESTAZIONI ELEVATE

ROBUSTI ma al tempo stesso compatti
per garantire la massima flessibilità di
assemblaggio

MATERIALI SILICON FREE

**CONFORMI ALLA NORMATIVA
ISO 14743**

GAMMA COMPLETA idonea all'utilizzo
con tubi di diverse tipologie

NICHELATI ELETTROLITICAMENTE al
fine di garantire la massima durata nel tempo

UTILIZZABILI CON VUOTO

SISTEMA PINZA STATICO al fine di
annullare i movimenti del tubo una volta
inserito, garantendo una tenuta perfetta

Ogni raccordo è **STUDIATO PER
GARANTIRE IL MASSIMO
PASSAGGIO POSSIBILE** in funzione del
diametro del tubo ed dell'eventuale filettatura

OR CON CORDA MAGGIORATA per
una maggiore tenuta e resistenza a vibrazioni e
movimenti laterali del tubo

M A D E I N I T A L Y



					
p. 8 / OTRC-R	p. 8 / OTRC-G	p. 9 / OTRC-N	p. 9 / OTROC-N	p. 9 / OTRMM	p. 10 / OTRME
					
p. 10 / OTRL-R	p. 10 / OTRL-G	p. 11 / OTRL-N	p. 11 / OTRT-R	p. 12 / OTRT-G	p. 12 / OTRT-N
					
p. 13 / OTA-G	p. 13 / OTRUC	p. 13 / OTRUC-N	p. 14 / OTRUL	p. 14 / OTRUL-N	p. 14 / OTRUT
					
p. 14 / OTRUT-N	p. 15 / OTRGJ				



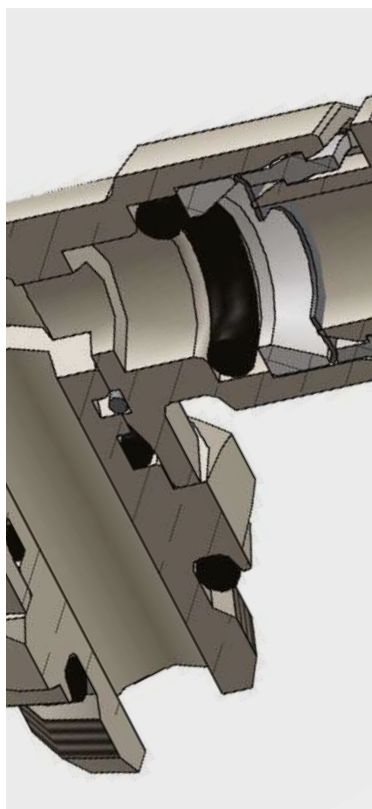

-20°C ÷ 80°C



Pressione d'esercizio:

16 Bar

Pressione negativa:

-750 mmHg (-0,999 Bar)



Aria Compressa e Vuoto



Conica gas BSPT ISO 7

da R1/8" to R1/2"

Cilindrica gas BSPP ISO 228

da G1/8" to G1/2"

Metrica ISO 262 M5 e M7

NPT ANSI B 1.20.1

da N1/8" a N1/2"

UNF ANSI B 1.1 10-32 UF



Poliammide, Poliuretano,

Polietilene

Corpo: ottone nichelato
UNI EN 12164 CW614N & UNI
EN 12164 CW617N

Collare: POM



Colletto: ottone nichelato
UNI EN 12164 CW614N

Guarnizione: NBR senza silicone

Pinza: acciaio inox AISI 301

Distanziale: PBT

Anello di tenuta per sistemi girevoli:
acciaio inox AISI 302



Prodotti conformi alla
direttiva 1907/2006



RoHS2

Prodotti conformi alla
direttiva 2011/65/EU

SILICON FREE

DETTAGLI COSTRUTTIVI

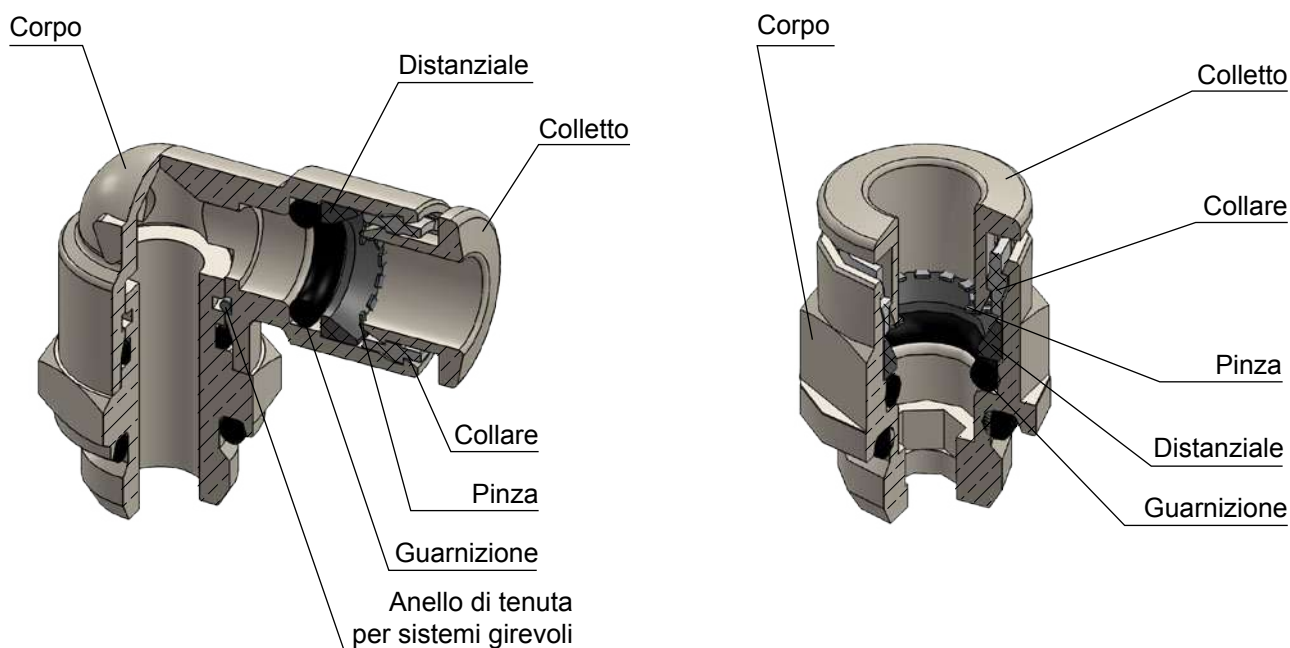

CONNESSIONE DEL TUBO AL RACCORDO

- Assicurarsi che il tubo sia sempre inserito completamente fino a battuta.
- Tagliare il tubo a 90° mediante l'utilizzo di un apposito cutter, inserirlo fino a battuta e tirarlo con accortezza per accertare il corretto inserimento.
- Se ci sono danni o imperfezioni sulla superficie del tubo o se lo stesso risulta ovalizzato si possono verificare delle perdite d'aria od una imprevista disconnessione. Verificare il tutto scrupolosamente.
- Il diametro esterno del tubo in poliuretano si espande in base alla pressione applicata. Pertanto il reinserimento del raccordo potrebbe non essere più possibile.
- Tagliare la parte di tubo agganciata al raccordo per poterlo riutilizzare.

DISCONNESSIONE DEL TUBO DAL RACCORDO

- Accertarsi che il tubo non sia in pressione prima di disconnettere lo stesso dal raccordo.
- Per sganciare il tubo premere l'anello di sgancio, tirare ed estrarre il tubo contemporaneamente.

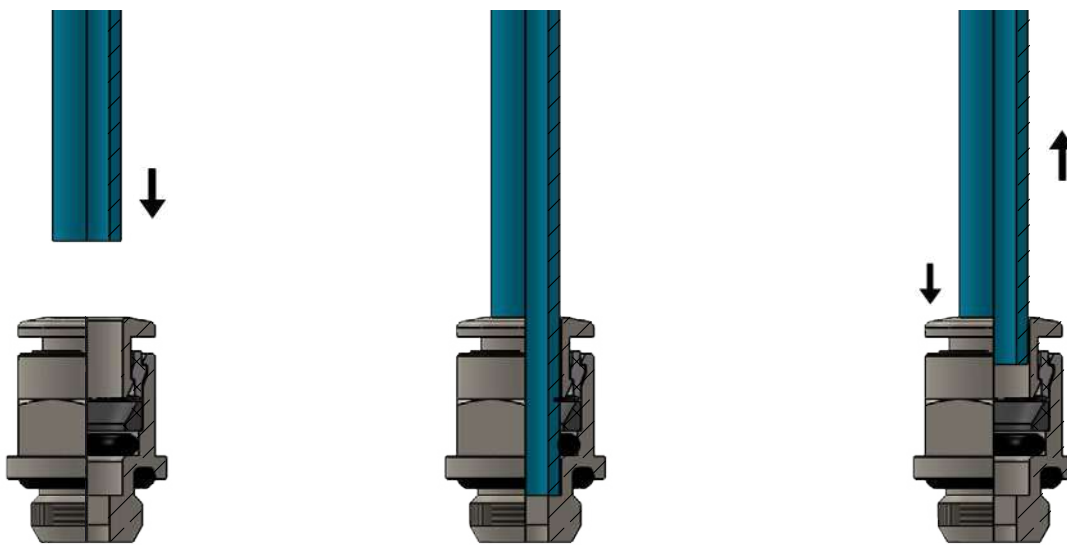

TOLLERANZA - TUBO METRICO

Ø TUBO (mm)	4	6	8	10	12
TOLLERANZA (mm)	±0,1	±0,1	±0,1	±0,15	±0,15

INSERIMENTO - TUBO METRICO

Ø TUBO (mm)	4	6	8	10	12
LUNGHEZZA DI INSERIMENTO TUBO (mm)	14	15,5	17,5	19	21

TOLLERANZA - TUBO IN POLLICI

Ø TUBO	5/32	1/4	5/16	3/8	1/2
TOLLERANZA (Inch)	±0,004	±0,004	±0,004	±0,006	±0,006

INSERIMENTO - TUBO IN POLLICI

Ø TUBO	5/32	1/4	5/16	3/8	1/2
LUNGHEZZA DI INSERIMENTO TUBO (Inch)	0,551	0,629	0,688	0,728	0,846



OTRC-R

Diritto maschio conico BSPT nichelato

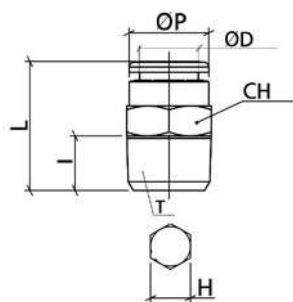

CODICI	ØD	T	ØP	I	L	CH	H	GR.
OTRC04R01	4	R1/8"	10	8	18,5	10	3	7,0
OTRC04R02		R1/4"	10	10	20	14	3	15,0
OTRC06R01	6	R1/8"	12	8	21	12	4	9,0
OTRC06R02		R1/4"	12	10	20	14	4	14,0
OTRC08R01	8	R1/8"	14	8	26	14	5	15,0
OTRC08R02		R1/4"	14	10	24	14	6	14,0
OTRC08R03		R3/8"	14	11	22	17	6	24,0
OTRC10R02	10	R1/4"	16	10	31	16	6	22,0
OTRC10R03		R3/8"	16	11	26	17	8	23,0
OTRC10R04		R1/2"	16	14	26,5	22	8	45,0
OTRC12R02	12	R1/4"	19	10	33	19	6	21,0
OTRC12R03		R3/8"	19	11	29,5	19	10	27,0
OTRC12R04		R1/2"	19	14	27	22	10	44,5

OTRC-G

Diritto maschio cilindrico BSPP & metrico nichelato

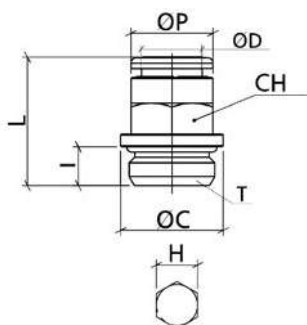

CODICI	ØD	T	ØP	ØC	I	L	CH	H	GR.
OTRC04M5	4	M5X0,8	10	7	4	19	9	2,5	5,0
OTRC04G01		G1/8"	10	14	5,5	18	10	3	8,0
OTRC04G02		G1/4"	10	16	6,5	18	10	3	11,0
OTRC06M5	6	M5X0,8	12	7	4	21	11	2,5	8,0
OTRC06G01		G1/8"	12	14	5,5	19,5	12	4	9,0
OTRC06G02		G1/4"	12	16	6,5	19,5	12	4	12,0
OTRC08G01	8	G1/8"	14	14	5,5	24,5	14	5	14,0
OTRC08G02		G1/4"	14	16	6,5	21,5	14	6	13,5
OTRC08G03		G3/8"	14	20	7,5	21,5	14	6	20,0
OTRC10G02	10	G1/4"	16	16	6,5	27,5	16	6	19,0
OTRC10G03		G3/8"	16	20	7,5	25	16	8	22,0
OTRC10G04		G1/2"	16	25	9	25	16	8	33,0
OTRC12G02	12	G1/4"	19	16	6,5	30	19	6	28,0
OTRC12G03		G3/8"	19	22	7,5	29,5	19	10	30,0
OTRC12G04		G1/2"	19	25	9	28	19	10	37,0



OTRC-N

Diritto maschio NPT nichelato

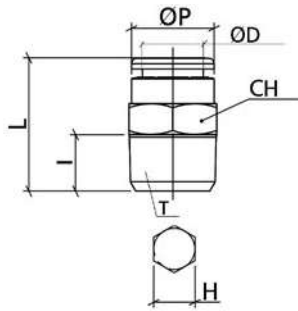

CODICI	ØD	T	ØP	I	L	CH	H	GR.
OTRC532N01	5/32"	N1/8"	0,393	0,334	0,748	7/16"	1/8"	9,0
OTRC532N02		N1/4"	0,393	0,413	0,787	9/16"	1/8"	16,0
OTRC1-4N01	1/4"	N1/8"	0,511	0,334	0,885	1/2"	3/16"	11,0
OTRC1-4N02		N1/4"	0,511	0,413	0,885	9/16"	3/16"	15,0
OTRC516N01	5/16"	N1/8"	0,551	0,334	1,062	9/16"	3/16"	15,5
OTRC516N02		N1/4"	0,551	0,413	1,003	9/16"	1/4"	16,0
OTRC516N03		N3/8"	0,551	0,452	0,925	11/16"	1/4"	25,0
OTRC38N01	3/8"	N1/8"	0,629	0,334	1,122	11/16"	3/16"	21,5
OTRC38N02		N1/4"	0,629	0,413	1,181	11/16"	1/4"	25,0
OTRC38N03		N3/8"	0,629	0,452	1,003	11/16"	5/16"	24,0
OTRC38N04		N1/2"	0,629	0,570	1,043	7/8"	5/16"	46,0
OTRC1-2N02	1/2"	N1/4"	0,748	0,413	1,318	7/8"	1/4"	37,0
OTRC1-2N03		N3/8"	0,748	0,452	1,338	7/8"	3/8"	39,0
OTRC1-2N04		N1/2"	0,748	0,570	1,181	7/8"	3/8"	43,0

OTROC-N

Diritto maschio tondo UNF nichelato

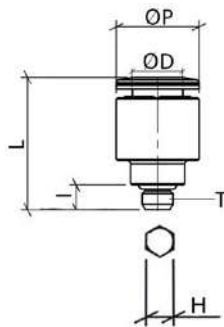

CODICI	ØD	T	ØP	I	L	H	GR.
OTROC532UF1032	5/32"	UNF 10-32	0,393	0,157	0,748	3/32"	12,0
OTROC1-4UF1032	1/4"	UNF 10-32	0,511	0,157	0,846	3/32"	16,0

OTRMM

Passaparete nichelato

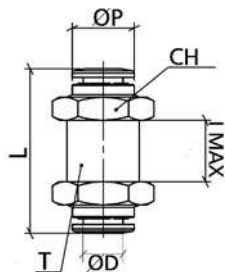

CODICI	ØD	T	ØP	L	I MAX	CH	GR.
OTRMM04-532	4	M12X1	10	30	12	16	23,0
OTRMM0600	6	M14X1	12	35,5	15	17	31,0
OTRMM08-516	8	M16X1	14	36,5	16	19	36,0
OTRMM1000	10	M20X1	16	43	19	24	70,0
OTRMM1200	12	M22X1,5	19	44	20	25	76,0

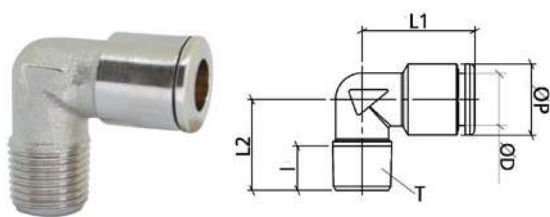

OTRME**Gomito maschio fisso conico BSPT nichelato**

CODICI	ØD	T	ØP	I	L1	L2	GR.
OTRME04R01	4	R1/8"	10	8	18	15,5	11,0
OTRME06R01	6	R1/8"	12	8	19,5	15,5	15,0
OTRME06R02		R1/4"	12	10	20,5	19,25	25,0
OTRME08R01	8	R1/8"	14	8	22,5	16,5	20,0
OTRME08R02		R1/4"	14	10	22,5	19,25	24,0
OTRME10R02	10	R1/4"	16	10	25,5	20,5	26,0

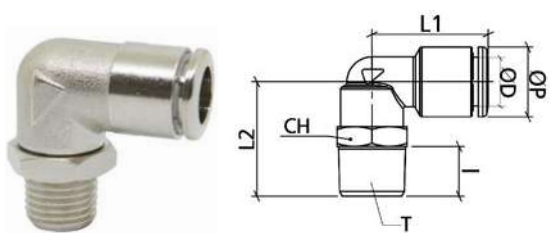
OTRL-R**Gomito maschio girevole conico BSPT nichelato**

CODICI	ØD	T	ØP	I	L1	L2	CH	GR.
OTRLO4R01	4	R1/8"	10	8	19,5	20,5	13	20,0
OTRLO4R02		R1/4"	10	10	19,5	23	14	23,0
OTRLO6R01	6	R1/8"	12	8	21	20,5	13	20,0
OTRLO6R02		R1/4"	12	10	21	23	14	24,0
OTRLO8R01	8	R1/8"	14	8	23	20,5	13	22,0
OTRLO8R02		R1/4"	14	10	23	23	14	26,0
OTRLO8R03		R3/8"	14	11	23	24,5	17	32,0
OTRLO10R02	10	R1/4"	16	10	26	25,5	16	41,0
OTRLO10R03		R3/8"	16	11	26	27	17	45,0
OTRLO10R04		R1/2"	16	14	26	30	22	59,0
OTRLO12R02	12	R1/4"	19	10	31	28	20	56,0
OTRLO12R03		R3/8"	19	11	31	28,5	20	59,0
OTRLO12R04		R1/2"	19	14	31	31,5	22	70,0

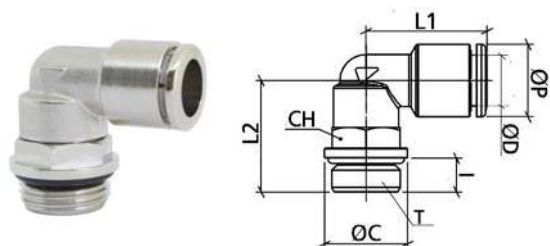
OTRL-G**Gomito maschio girevole cilindrico BSPP & metrico nichelato**

CODICI	ØD	T	ØP	ØC	I	L1	L2	CH	GR.
OTRLO4M5	4	M5X0,8	10	7	4	18	15	8	5,0
OTRLO4G01		G1/8"	10	13	5,5	19,5	19	13	19,0
OTRLO4G02		G1/4"	10	16	6,5	19,5	21,5	13	22,0
OTRLO6M5	6	M5X0,8	12	7	4	19,5	16	8	11,0
OTRLO6G01		G1/8"	12	13	5,5	21	19	13	20,0
OTRLO6G02	G1/4"	12	16	6,5	21	21,5	13	24,0	
OTRLO8G01	8	G1/8"	14	13	5,5	23	19	13	22,0
OTRLO8G02		G1/4"	14	16	6,5	23	21,5	13	24,0
OTRLO8G03		G3/8"	14	20	7,5	23	23	13	28,0
OTRLO10G02	10	G1/4"	16	16	6,5	26	23	16	35,0
OTRLO10G03		G3/8"	16	20	7,5	26	26	16	43,5
OTRLO10G04		G1/2"	16	25	9	26	27,5	16	52,0
OTRLO12G02	12	G1/4"	19	16	6,5	31	25,5	20	55,0
OTRLO12G03		G3/8"	19	20	7,5	31	26,5	20	55,0
OTRLO12G04		G1/2"	19	25	9	31	29	20	63,0



OTRL-N

Gomito maschio girevole NPT nichelato

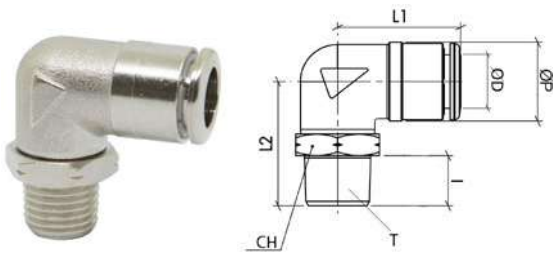

CODICI	ØD	T	ØP	I	L1	L2	CH	GR.
OTRL532UF1032	5/32"	UNF 10/32	0,394	0,157	0,709	0,591	3/8"	11,0
OTRL532N01		N1/8"	0,394	0,334	0,768	0,827	9/16"	20,5
OTRL532N02		N1/4"	0,394	0,413	0,768	0,925	9/16"	24,0
OTRL1-4N01	1/4"	N1/8"	0,512	0,334	0,846	0,827	9/16"	23,0
OTRL1-4N02		N1/4"	0,512	0,413	0,846	0,925	9/16"	26,0
OTRL516N01	5/16"	N1/8"	0,551	0,334	0,906	0,827	9/16"	23,0
OTRL516N02		N1/4"	0,551	0,413	0,906	0,925	9/16"	24,0
OTRL516N03		N3/8"	0,551	0,452	0,906	0,984	11/16"	34,0
OTRL38N01	3/8"	N1/8"	0,650	0,334	1,004	0,945	11/16"	40,0
OTRL38N02		N1/4"	0,650	0,413	1,004	1,024	11/16"	43,0
OTRL38N03		N3/8"	0,650	0,452	1,024	1,083	11/16"	47,0
OTRL38N04		N1/2"	0,650	0,570	1,004	1,201	7/8"	60,0
OTRL1-2N02	1/2"	N1/4"	0,768	0,413	1,220	1,122	7/8"	58,0
OTRL1-2N03		N3/8"	0,768	0,452	1,220	1,161	7/8"	61,0
OTRL1-2N04		N1/2"	0,768	0,570	1,220	1,280	7/8"	67,0

OTRT-R

T maschio girevole conico BSPT nichelato

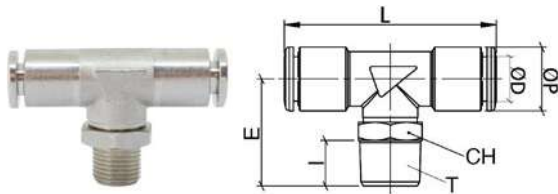

CODICI	ØD	T	ØP	I	E	L	CH	GR.
OVRT04R01	4	R1/8"	10	8	21	39	13	27,0
OVRT04R02		R1/4"	10	10	23,5	39	14	31,0
OVRT06R01	6	R1/8"	12	8	21	42	13	30,0
OVRT06R02		R1/4"	12	10	23,5	42	14	34,0
OVRT08R01	8	R1/8"	14	8	21	46,5	13	34,0
OVRT08R02		R1/4"	14	10	23,5	46,5	14	37,0
OVRT08R03		R3/8"	14	11	25	46,5	17	44,0
OVRT10R02	10	R1/4"	16	10	25,5	52	16	55,0
OVRT10R03		R3/8"	16	11	27	52	17	58,5
OVRT10R04		R1/2"	16	14	30	52	22	73,0
OVRT12R02	12	R1/4"	19	10	28	62	20	77,0
OVRT12R03		R3/8"	19	11	28,5	62	20	80,0
OVRT12R04		R1/2"	19	14	31,5	62	22	81,0



OTRT-G

T maschio girevole cilindrico BSPP & metrico nichelato

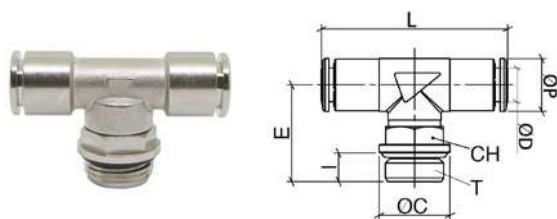

CODICI	ØD	T	ØP	I	E	L	CH	GR.
OTRT04M5	4	M5X0,8	10	4	17	32	8	17,0
OTRT04G01		G1/8"	10	5,5	19,5	39	13	29,0
OTRT04G02		G1/4"	10	6,5	22	39	13	29,0
OTRT06M5	6	M5X0,8	12	4	17	40	8	21,0
OTRT06G01		G1/8"	12	5,5	19,5	42	13	29,0
OTRT06G02		G1/4"	12	6,5	22	42	13	32,0
OTRT08G01	8	G1/8"	14	5,5	19,5	46,5	13	33,0
OTRT08G02		G1/4"	14	6,5	22	46,5	13	35,5
OTRT08G03		G3/8"	14	7,5	23,5	46,5	13	39,0
OTRT10G02	10	G1/4"	16	6,5	23	52	16	52,0
OTRT10G03		G3/8"	16	7,5	26	52	16	56,0
OTRT10G04		G1/2"	16	9	27,5	52	16	64,5
OTRT12G02	12	G1/4"	19	6,5	25,5	62	20	75,0
OTRT12G03		G3/8"	19	7,5	26,5	62	20	77,0
OTRT12G04		G1/2"	19	9	29	62	20	82,0

OTRT-N

T maschio girevole NPT nichelato

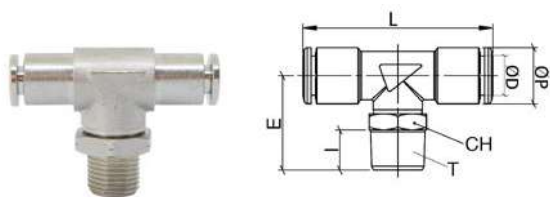

CODICI	ØD	T	ØP	I	E	L	CH	GR.
OTRT532UF1032	5/32"	UNF 10-32	0,393	0,157	0,669	1,259	3/8"	17,0
OTRT532N01		N1/8"	0,393	0,334	0,846	1,535	9/16"	28,0
OTRT532N02		N1/4"	0,393	0,413	0,944	1,535	9/16"	31,0
OTRT1-4N01	1/4"	N1/8"	0,551	0,334	0,846	1,673	9/16"	33,0
OTRT1-4N02		N1/4"	0,551	0,413	0,944	1,673	9/16"	36,0
OTRT516N01	5/16"	N1/8"	0,551	0,334	0,846	1,830	9/16"	34,0
OTRT516N02		N1/4"	0,551	0,413	0,944	1,830	9/16"	37,0
OTRT38N02	3/8"	N1/4"	0,649	0,413	1,023	2,027	11/16"	58,0
OTRT38N03		N3/8"	0,649	0,452	1,082	2,027	11/16"	61,0
OTRT1-2N02	1/2"	N1/4"	0,767	0,413	1,122	2,440	7/8"	75,0
OTRT1-2N03		N3/8"	0,767	0,452	1,161	2,440	7/8"	78,0



OTA-G

Adattatore cilindrico BSPP & metrico nichelato

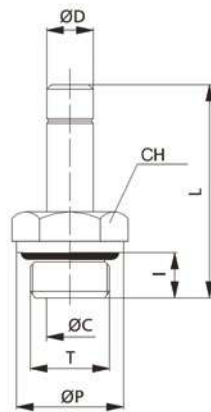

CODICI	ØD	T	ØP	ØC	I	L	CH	DN	GR.
OTA04M5	4	M5	8,0	2,0	4,0	24,5	8	2,0	3,0
OTA04M7		M7	-	4,0	6,0	26,0	10	2,0	5,0
OTA04G01		G1/8"	13,0	6,0	6,0	28,0	13	2,0	10,0
OTA04G02		G1/4"	16,0	7,5	8,0	30,0	13	2,0	11,0
OTA06M5	6	M5	8,0	2,6	4,0	26,0	8	2,6	5,0
OTA04M7		M7	-	4,0	6,0	28,0	10	4,0	7,0
OTA06G01		G1/8"	13,0	6,0	6,0	29,5	13	4,0	9,0
OTA06G02	G1/4"	16,0	7,5	8,0	32,0	13	4,0	13,0	
OTA08G01	8	G1/8"	13,0	6,0	6,0	31,0	13	6,0	10,0
OTA08G02		G1/4"	16,0	7,5	8,0	33,5	13	6,0	13,0
OTA08G03		G3/8"	20,0	9,0	9,0	35,5	13	6,0	21,0
OTA10G01	10	G1/8"	13,0	6,0	6,0	35,5	13	6,0	17,0
OTA10G02		G1/4"	16,0	8,0	8,0	38,0	13	8,0	15,0
OTA10G03		G3/8"	20,0	8,0	9,0	41,0	13	8,0	26,0
OTA12G02	12	G1/4"	16,0	8,0	8,0	39,0	13	8,0	22,0
OTA12G03		G3/8"	20,0	11,0	9,0	42,0	13	10,0	22,0
OTA12G04		G1/2"	24,0	13,0	11,0	44,0	16	10,0	35,0

OTRUC

Intermedio diritto per tubo metrico nichelato

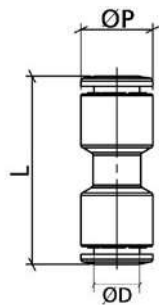

CODICI	ØD	ØP	L	GR.
OTRUC04-532	4	10	29	9,0
OTRUC0600	6	12	32	12,0
OTRUC08-516	8	14	35,5	16,0
OTRUC1000	10	16	39,5	21,0
OTRUC1200	12	19	44	37,0

OTRUC-N

Intermedio diritto per tubo in pollici nichelato

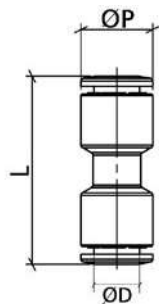

CODICI	ØD	ØP	L	GR.
OTRUC04-532	5/32"	0,393	1,141	9,0
OTRUC1-4	1/4"	0,511	1,299	14,0
OTRUC08-516	5/16"	0,551	1,397	16,0
OTRUC38	3/8"	0,629	1,515	21,0
OTRUC1-2	1/2"	0,748	1,732	37,0



OTRUL

Intermedio a gomito per tubo metrico nichelato

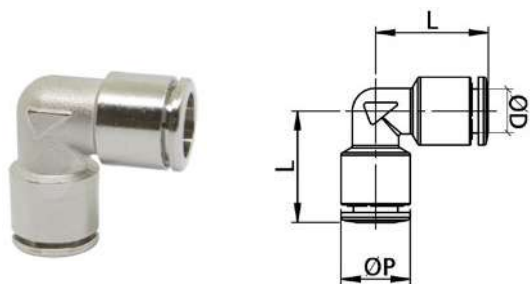

CODICI	ØD	ØP	L	GR.
OTRUL04-532	4	10	18	12,0
OTRUL0600	6	12	19,5	14,0
OTRUL08-516	8	14	22,5	20,0
OTRUL1000	10	16	25,5	26,0
OTRUL1200	12	19	29	49,0

OTRUL-N

Intermedio a gomito per tubo in pollici nichelato

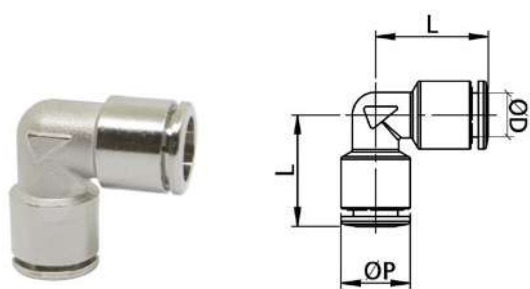

CODICI	ØD	ØP	L	GR.
OTRUL04-532	5/32"	0,393	0,708	12,0
OTRUL1-4	1/4"	0,551	0,826	19,0
OTRUL08-516	5/16"	0,551	0,885	20,0
OTRUL38	3/8"	0,649	0,984	28,0
OTRUL1-2	1/2"	0,767	1,122	43,0

OTRUT

Intermedio a T per tubo metrico nichelato

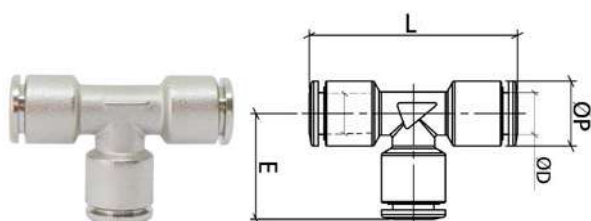

CODICI	ØD	ØP	E	L	GR.
OTRUT04-532	4	10	18	36	17,0
OTRUT0600	6	12	19,5	39	20,0
OTRUT08-516	8	14	22,5	45	30,0
OTRUT1000	10	16	25,5	51	37,0
OTRUT1200	12	19	29	58	68,0

OTRUT-N

Intermedio a T per tubo in pollici nichelato

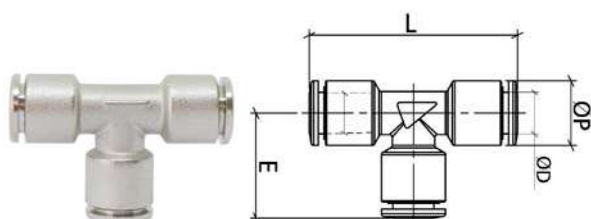

CODICI	ØD	ØP	E	L	GR.
OTRUT04-532	5/32"	0,393	0,708	1,417	16,9
OTRUT1-4	1/4"	0,551	0,826	1,633	26,8
OTRUT08-516	5/16"	0,551	0,885	1,771	29,7
OTRUT38	3/8"	0,649	0,984	1,988	38,3
OTRUT1-2	1/2"	0,767	1,122	2,263	58,7



OTRGJ

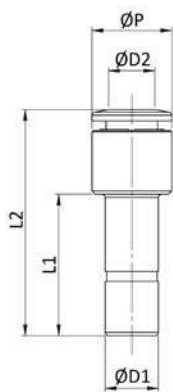

Riduzione codolo - tubo metrico nichelato

CODICI	ØD1	ØD2	ØP	L1	L2	GR.
OTRGJ0604	6	4	10	19,50	31	6,0
OTRGJ0806	8	6	12	21,50	34,50	8,0
OTRGJ1008	10	8	14	22,50	36,50	13,0
OTRGJ1210	12	10	16	25,0	40,50	18,0

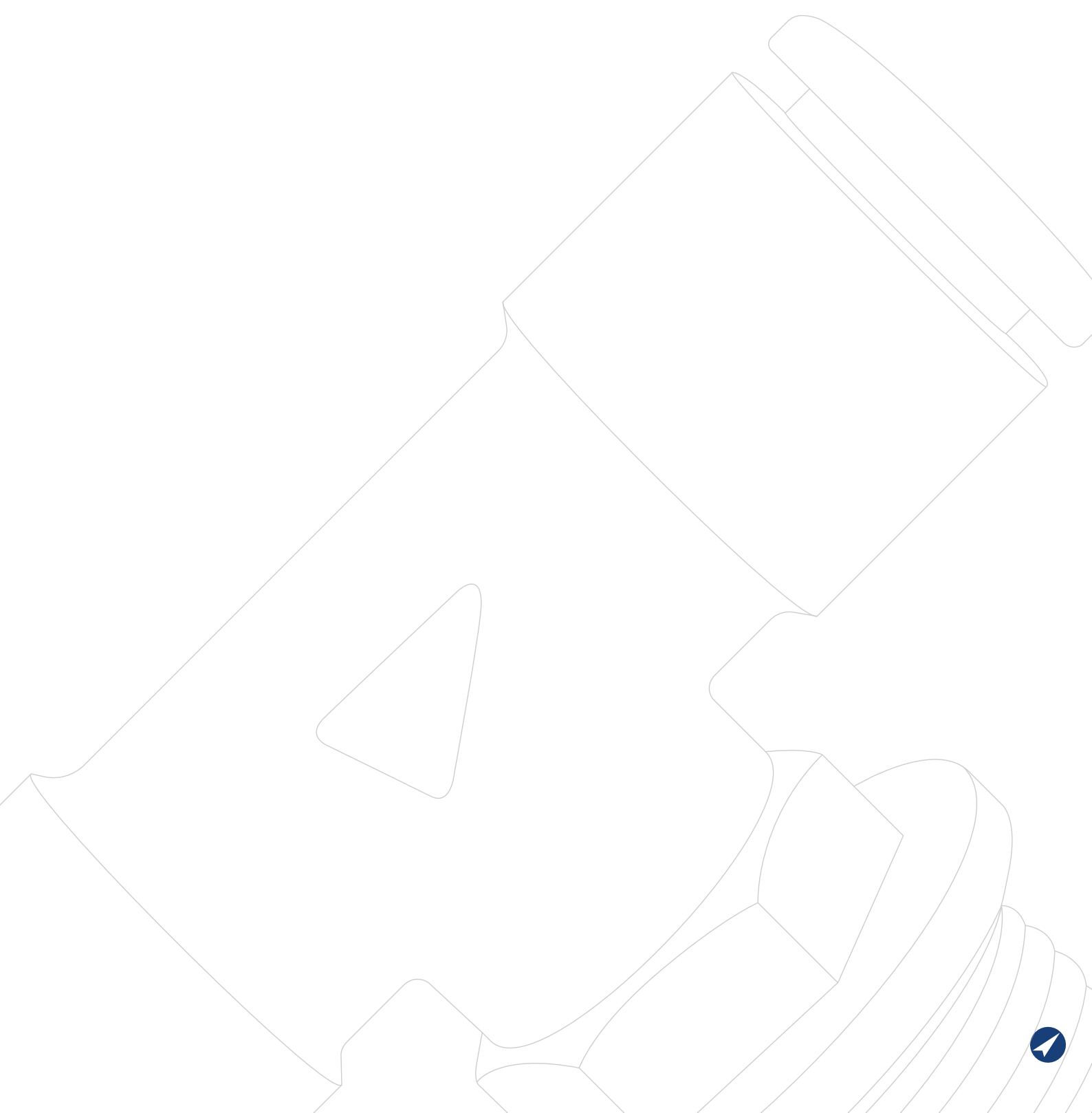

TUBO IN POLIURETANO A BASE POLIESTERE

PLUS

**ECCELLENTE FLESSIBILITÀ CHE
PERMETTE UN OTTIMO RAGGIO DI
CURVATURA**

**IDEALE PER APPLICAZIONI
ROBOTICHE**

**LEGGERO, DUREVOLE, RESISTENTE
ALL'ABRASIONE E AGLI AGENTI
CHIMICI**

**IDEALE PER COLLEGAMENTI
PNEUMATICI IN CONDIZIONI
AMBIENTALI CRITICHE**

**AUTOMODELLANTE IN OGNI
SITUAZIONE**

**DISPONIBILE IN 8 COLORI E
FACILMENTE GESTIBILE GRAZIE ALLA
BOBINA IN PLASTICA**

**SILICON FREE ADATTO NEI
SETTORI DELLA VERNICIATURA E
DELL'AUTOMOTIVE**

**TENUTA AL VUOTO GRAZIE ALLA
SUPERFICIE PARTICOLARMENTE
DURA**





p. 21 / **PUES**



p. 21 / **PUES-BX**





0°C ÷ +60°C



Pressione d'esercizio:

Vedi in tabella

Pressione di scoppio:

Vedi in tabella

Pressione negativa:

-750 mmHg (- 0,999 Bar)



Aria compressa e vuoto.

Da non utilizzare in applicazioni con acqua.

TOLLERANZE

da Ø3 a Ø8: ± 0,1

da Ø10 a Ø16: ± 0,15

DUREZZA

Shore 98 A



Poliuretano a base poliestere

CARATTERISTICHE

Il tubo in poliuretano a base poliestere ha un'alta flessibilità a basse temperature ed una buona resistenza all'usura ed alle sostanze chimiche.



Prodotti conformi alla direttiva 1907/2006

RoHS2

Prodotti conformi alla direttiva 2011/65/EU

SILICON FREE

SCHEDA TECNICA

Tubo in poliuretano a base poliestere

CODICE	Ø ODxID	MINIMO RAGGIO DI CURVATURA (mm)	PRESSIONE D'UTILIZZO A 23°C (Bar)	PRESSIONE DI SCOPPIO A 23°C (Bar)	GR./MT	Q.TÀ PER MATASSA (mt)
PUES0302	3X2	8	10,0	30,0	7,5	100
PUES0402	4X2	12	10,0	30,0	10,0	100
PUES0425	4X2,5	12	10,0	30,0	9,0	100
PUES0604	6X4	15	8,5	25,5	18,0	100
PUES0805	8X5	20	8,5	25,5	35,0	100
PUES0855	8X5,5	20	8,5	25,5	38,0	100
PUES1065	10X6,5	25	8,5	25,5	55,0	100
PUES1007	10X7	25	8,0	24,0	49,0	100
PUES1208	12X8	35	8,5	25,5	78,0	100
PUES1209	12X9	35	7,0	21,0	61,0	100
PUES1410	14X10	45	8,0	18,0	108,0	50
PUES1611	16X11	50	8,0	18,0	132,0	50
PUES1612	16X12	60	7,0	16,0	122,0	50



PUES



Tube in poliuretano a base poliestere in bobine

Misure ODxID	 Azzurro	 Nero	 Rosso	 Giallo	 Verde	 Grigio	 Trasparente	 Azzurro trasparente
3X2	PUES0302AZ							
4X2	PUES0402AZ							
4X2,5	PUES0425AZ	PUES0425NE	PUES0425RO	PUES0425GL	PUES0425VD	PUES0425SL	PUES0425TR	PUES0425AZTR
6X4	PUES0604AZ	PUES0604NE	PUES0604RO	PUES0604GL	PUES0604VD	PUES0604SL	PUES0604TR	PUES0604AZTR
8X5	PUES0805AZ			PUES0805GL				
8X5,5	PUES0855AZ	PUES0855NE	PUES0855RO	PUES0855GL	PUES0855VD	PUES0855SL	PUES0855TR	PUES0855AZTR
10X6,5	PUES1065AZ			PUES1065GL				
10X7	PUES1007AZ	PUES1007NE	PUES1007RO	PUES1007GL	PUES1007VD		PUES1007TR	PUES1007AZTR
12X8	PUES1208AZ	PUES1208NE		PUES1208GL				
12X9	PUES1209AZ	PUES1209NE	PUES1209RO	PUES1209GL	PUES1209VD	PUES1209SL	PUES1209TR	PUES1209AZTR
14X10	PUES1410AZ							
16X11	PUES1611AZ							
16X12	PUES1612AZ							

PUES-BX



Tube in poliuretano a base poliestere in box

Misure ODxID	 Azzurro	 Nero	 Rosso	 Giallo	 Verde	 Grigio	 Trasparente	 Azzurro trasparente
3X2	PUES0302AZ-25BX							
4X2	PUES0402AZ-25BX							
4X2,5	PUES0425AZ-25BX	PUES0425NE-25BX	PUES0425RO-25BX	PUES0425GL-25BX	PUES0425VD-25BX	PUES0425SL-25BX	PUES0425TR-25BX	PUES0425AZTR-25BX
6X4	PUES0604AZ-25BX	PUES0604NE-25BX	PUES0604RO-25BX	PUES0604GL-25BX	PUES0604VD-25BX	PUES0604SL-25BX	PUES0604TR-25BX	PUES0604AZTR-25BX
8X5	PUES0805AZ-25BX			PUES0805GL-25BX				
8X5,5	PUES0855AZ-25BX	PUES0855NE-25BX	PUES0855RO-25BX	PUES0855GL-25BX	PUES0855VD-25BX	PUES0855SL-25BX	PUES0855TR-25BX	PUES0855AZTR-25BX
10X6,5	PUES1065AZ-25BX			PUES1065GL-25BX				
10X7	PUES1007AZ-25BX	PUES1007NE-25BX	PUES1007RO-25BX	PUES1007GL-25BX	PUES1007VD-25BX		PUES1007TR-25BX	PUES1007AZTR-25BX
12X8	PUES1208AZ-25BX	PUES1208NE-25BX		PUES1208GL-25BX				
12X9	PUES1209AZ-25BX	PUES1209NE-25BX	PUES1209RO-25BX	PUES1209GL-25BX	PUES1209VD-25BX	PUES1209SL-25BX	PUES1209TR-25BX	PUES1209AZTR-25BX
14X10	PUES1410AZ-25BX							
16X11	PUES1611AZ-25BX							
16X12	PUES1612AZ-25BX							





Tierre Group S.p.a.

Via dell'Industria, 18 - 20032 Cormano (MI)

Tel. +39 02 663088.1 - Fax +39 02 66304172

www.tierregroup.com - info@tierregroup.com

C.F. e P.IVA 12437570158

Cap. Soc. Euro 120.000,00 i.v. - REA MI-1558390

Catalogo Innesti Rapidi in Ottone - Ed. 1.1 - 02/19

LubeTeam Hydraulic S.r.l.

Administration and Headquarter:

Via Tufara Scautieri, 6

83018 - San Martino Valle Caudina (AV)

Office and Warehouse:

S.S. 7 Appia, Km. 237,00

82011 - Airola BN

ITALY

Tel. +39 0823 950 994

Fax +39 0823 412 546

www.lubeteam.it info@lubeteam.it

Italian VAT / C.F. e P.IVA: 01251720627

Follow us



This document is the property of LubeTeam Hydraulic S.r.l. All data reported here are for the exclusive use of the Receiver. Reproduction is not authorized without writing permission, in all or in part of the content of this document, in accordance to Law 633 art. 171, dated April 22, 1941.

Il presente documento è di proprietà della LubeTeam Hydraulic S.r.l. I dati riportati sono per esclusivo del destinatario. La riproduzione, di tutto o in parte, non è autorizzata senza permesso scritto secondo l'art. 171 della L. 633 del 22 Aprile 1941.