

UFI FILTERS
CFA



 HYDRAULIC
COMPONENTS
& FLUID CONTAMINATION
CONTROL



CFA ACCESSORIES

DESCRIPTION

Filling breathers

MATERIALS

Housing, flange and basket: Zinc plated steel

Cap: Chrome plated steel

Seals: Sugheroil (NBR Nitrile for pressurised version only)

Filter element ((not replaceable):

Impregnated cellulose 3µm

Polyurethan foam 10µm

FLOW RATE

Qmax 750 l/min

WORKING TEMPERATURE

From -25°C to 110°C

HOW IT WORKS

CFA filling plugs include an inbuilt air breather and a protection basket against ingress of coarse parts (removable for CFA23). The connection to the tank is flanged with standard dimensions, with additional tank connection options for CFA23 (welding flange or plug extension).

For sizes CFA21 & CFA22 the plug has a safety chain.

COMPATIBILITY

Full with fluids HH-HL-HM-HV-HTG (according to ISO 6743/4). For fluids different than the above mentioned, please contact our Customer Service.



HYDRAULIC DIAGRAM

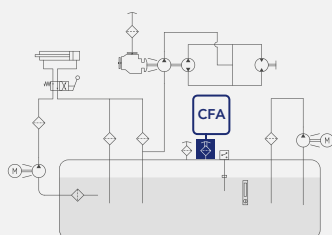

Is this datasheet the latest release? Please check on our website.

ORDERING AND OPTION CHART

C	F	A	COMPLETE FILTER FAMILY				
			SIZE & LENGTH	11	21	22	23
			MOUNTING PATTERN				
			S = DIN 24557/2 flange	S	S	S	S
			T = Plug extension	-	-	-	T
			W = Welding flange	-	-	-	W
			PRESSURIZATION VALVE				
			W = Without	W	W	W	W
			A = 35 kPa (0,35 bar)	-	A	A	A
			SEALS				
			C = Sugheroil	C	C	C	C
			N = NBR Nitrile (with A option only)	-	N	N	N
			FILTER MEDIA				
			CC = Impregnated cellulose 10 µm (3 µm in air)	CC	CC	CC	CC
			PE = Polyurethan foam 40 µm (10 µm in air)	PE	PE	PE	PE
			ACCESSORIES				
			P = Padlock holder	-	P	P	P
			S = Internal fixing chain (only for mounting pattern S)	-	S	S	S

DIMENSIONS

	D1	D2	D3	D4	Holes n°	D5	D6	H1	H2	DWG
CFA11S	47	29	52	M5	3	31	41	48	64	A
CFA21S	80	50	83	M5	6	52	73	57	78	B
CFA22S	80	50	83	M5	6	52	73	57	148	B
CFA23S	80	40	83	M5	6	42	73	57	100	B
CFA23W	80	38	83	-	-	40	-	53	100	C
CFA23TW	80	38	-	-	-	-	-	-	-	D
CFA23TA	70	38	-	-	-	-	-	-	-	D



INSTALLATION DRAWING

DWG A

DWG B

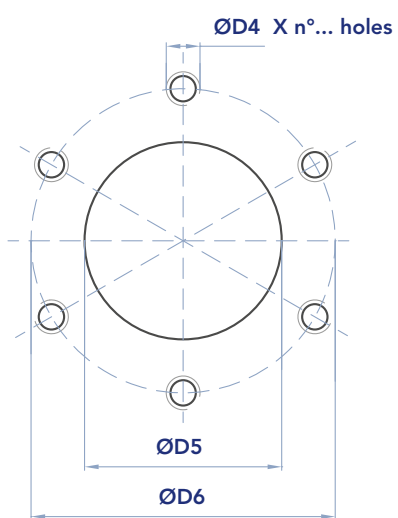
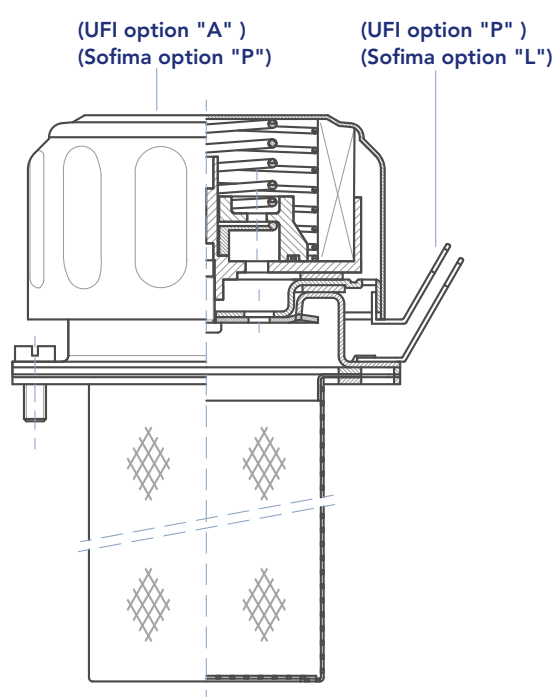
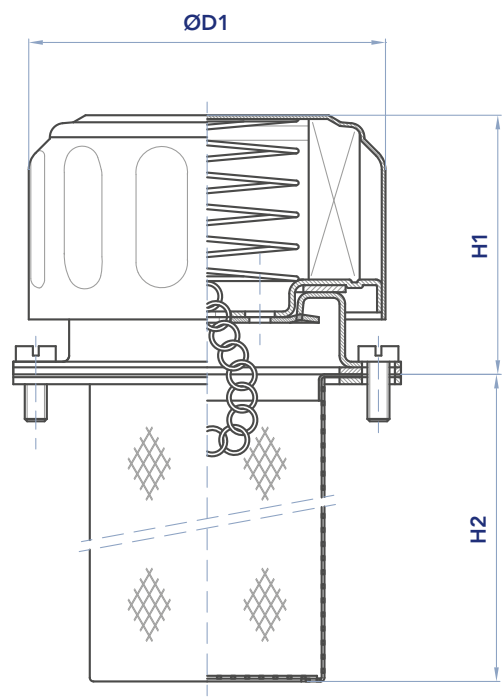

Tank connection:
DIN 24557/2

DIMENSIONS

DWG C

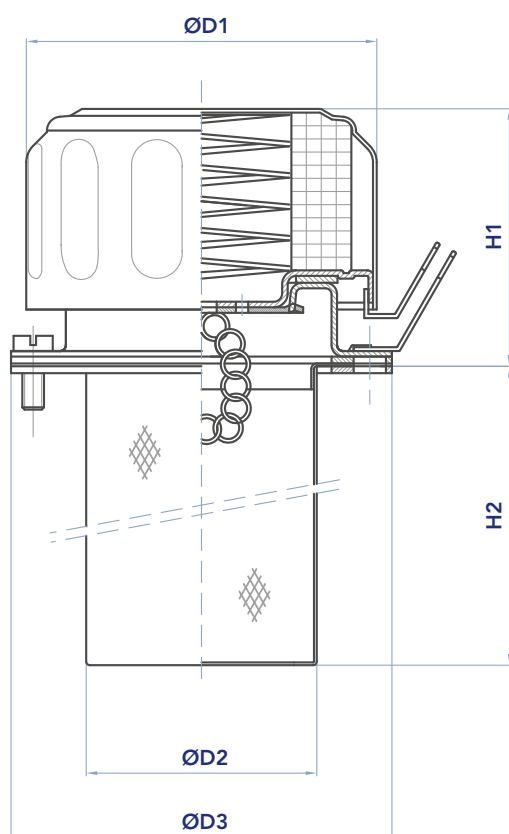

DWG D

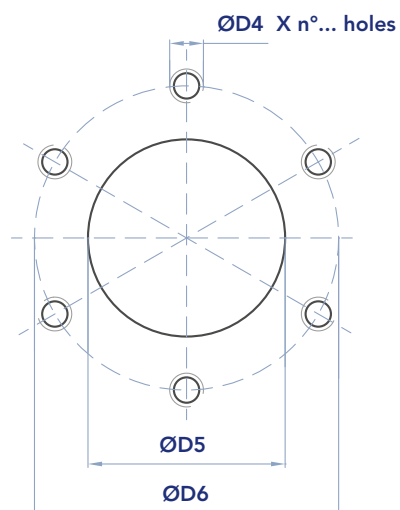
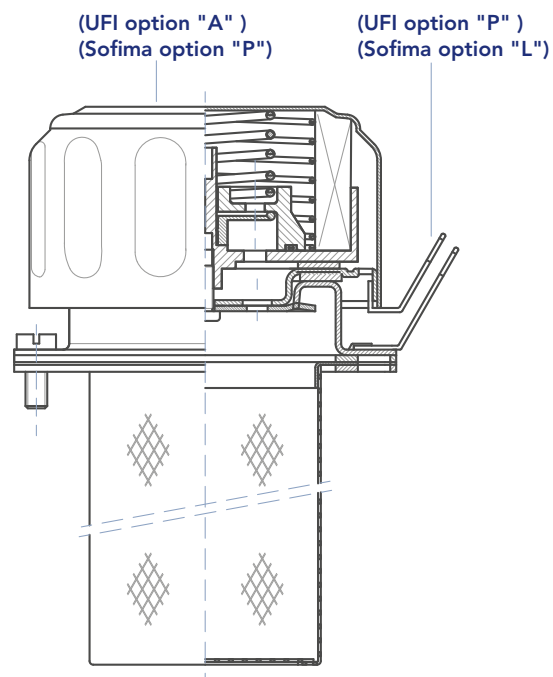

Tank connection:
DIN 24557/2

LubeTeam Hydraulic S.r.l.

Administration and Headquarter:

Via Tufara Scautieri, 6

83018 - San Martino Valle Caudina (AV)

Office and Warehouse:

S.S. 7 Appia, Km. 237,00

82011 - Airola BN

ITALY

Tel. +39 0823 950 994

Fax +39 0823 412 546

www.lubeteam.it info@lubeteam.it

Italian VAT / C.F. e P.IVA: 01251720627

Follow us



This document is the property of LubeTeam Hydraulic S.r.l. All data reported here are for the exclusive use of the Receiver. Reproduction is not authorized without writing permission, in all or in part of the content of this document, in accordance to Law 633 art. 171, dated April 22, 1941.

Il presente documento è di proprietà della LubeTeam Hydraulic S.r.l. I dati riportati sono per esclusivo del destinatario. La riproduzione, di tutto o in parte, non è autorizzata senza permesso scritto secondo l'art. 171 della L. 633 del 22 Aprile 1941.